

Bouquet Twisting Pop-Out Card

Stamps & Die:

MC-2838 Floral Hope Clear Set
 CCD-024 Twisting Explosion Pop-Out Die

Cardstock:

White
 1-149 Guava Sensation
From Darcie's
 PAC1298 Nouveau Lime

Other Supplies:

Black & Light Grey
 Dye Ink Pads
 Alcohol Markers
 Fine-Tipped Black Marker
 Paper Distresser or Scissors

Foam Tape
 Scor-Tape
 3 1/4" Circle Die

1. Fold 4 1/4" x 11" white cardstock in half to form a top-fold card base, and layer 4 1/4" x 5 1/2" Guava Sensation cardstock onto base.
2. Stamp single rose and leaf trio images repeatedly onto 4" x 5 1/4" white cardstock using light grey ink and masking as needed. Color images with alcohol markers, and layer image panel onto card front.
3. Stamp leafy bouquet image onto scrap white cardstock using black ink, and color with alcohol markers.
4. Die cut leafy bouquet image into 3 1/4" circle, and roughen edges using paper distresser or scissors blade.
5. Adhere image circle to upper part of card front using foam tape.
6. Stamp "Thinking of You" saying onto 1" x 1 1/2" white cardstock using black ink, and layer onto 1 1/4" x 1 3/4" Guava Sensation cardstock. Adhere to lower right of image circle using foam tape as shown.
7. Open card, and layer 4" x 5 1/4" Nouveau Lime cardstock onto upper and lower sections of card base inside.
8. To make twisting pop-out mechanism, die cut CCD-024 onto heavy white cardstock. Fold along the score lines as indicated below:

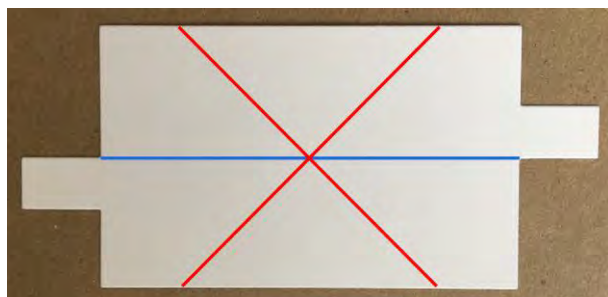

Blue Line = Mountain Fold
 Red Line = Valley Fold

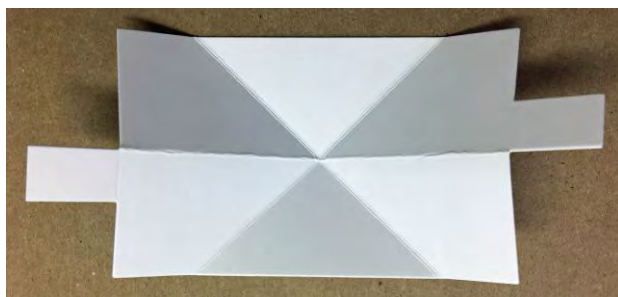

After Folding

9. Pinch together long sides of the mechanism to form a "dreidel" shape:

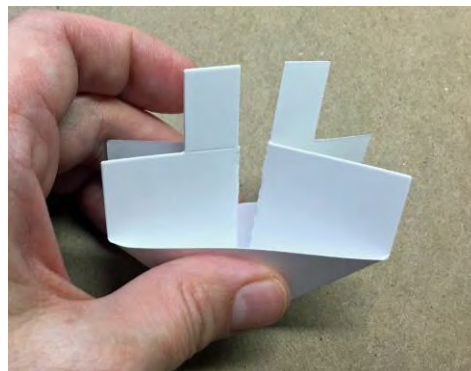
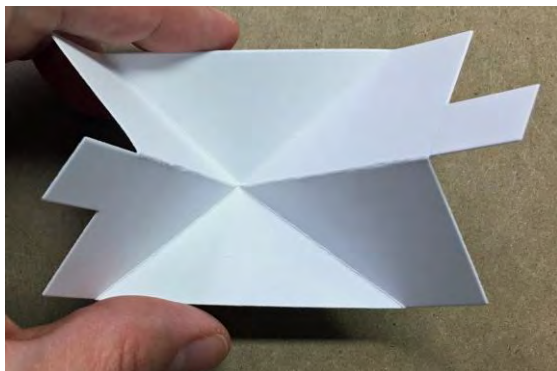

10. Flatten the mechanism, and place Scor-Tape as indicated in blue:

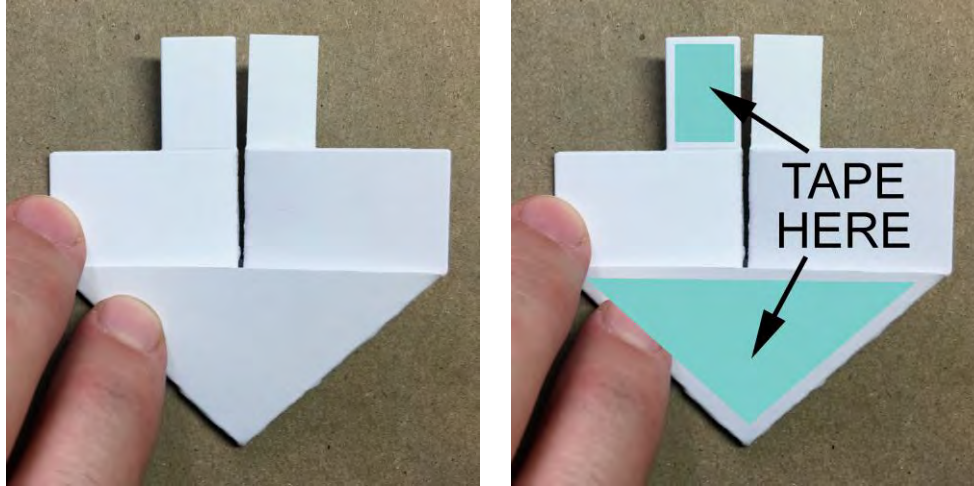

11. Turn over the mechanism, and repeat step #10 so that Scor-Tape is in the same spots on BOTH sides of mechanism.
12. To make the pop-out panel, score $2\frac{3}{4}$ " x 11" Wisteria cardstock at $2\frac{3}{4}$ ", $5\frac{1}{2}$ ", and $8\frac{1}{4}$ " on the long side. Fold on score lines in alternating directions (M-V-M) as shown here:

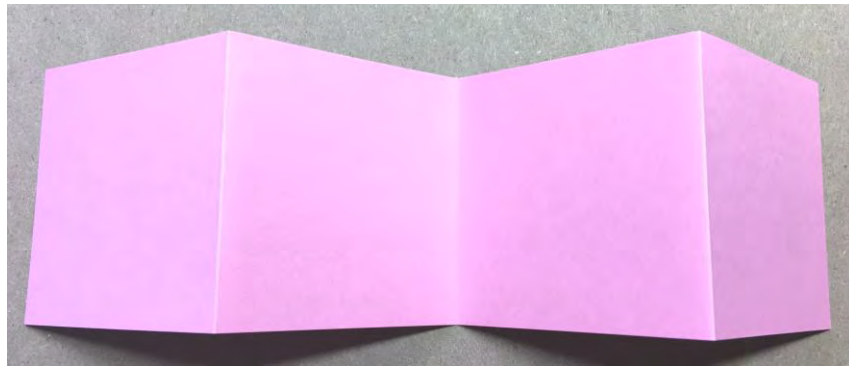

13. Next you will attach the pop-out panel to the mechanism. Flatten the pop-out panel so the two folds are facing towards you, and place panel in between both taped tabs of the mechanism and with the edges of pieces flush against each other so it looks like this:

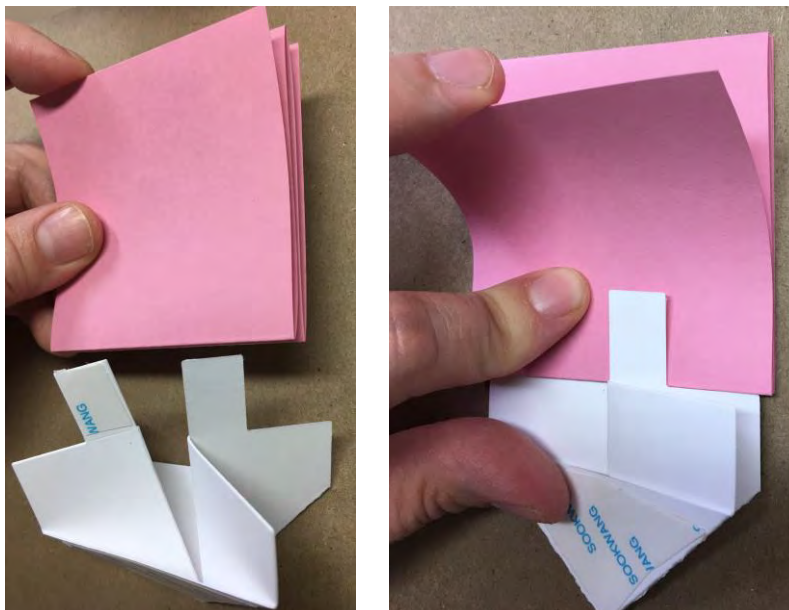

14. Remove tape liners, and adhere mechanism tabs to the pop-out panel:



Top View



Side Angle View

15. Rotate assembled panel/mechanism to the triangle point faces away from you, and place the point against the score line on the inside of the card base (making sure it's centered in the card):



16. Remove tape liners, and adhere panel/mechanism to the lower section on the card base inside. Close card so the panel/mechanism also adheres to the upper section of the card inside. Press firmly to make sure everything is attached well, and then open card to test the twisting pop-out feature:

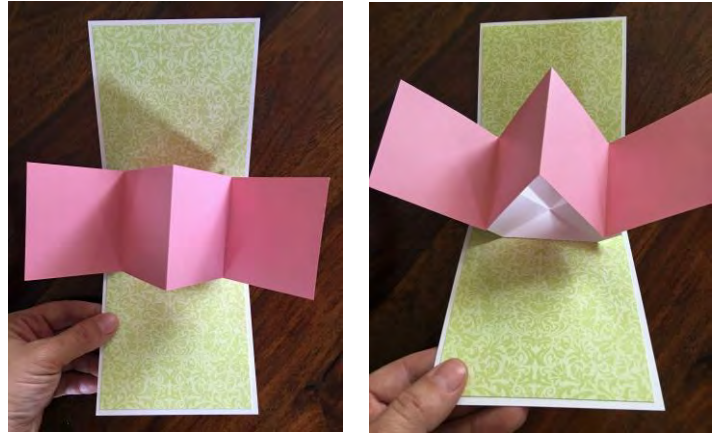

Open Card & Test
Twisting Pop-Out Feature

17. Stamp single rose and leaf trio images onto two pieces of 2 1/4" x 2 1/4" white cardstock using black ink and masking as needed, and then stamp phrases onto two pieces of 2 1/4" x 2 1/4" white cardstock using black ink as shown. Color images with alcohol markers, and use black marker to draw double lines around edges. (Optional: To add visual interest, we changed this slightly by using the "out-of-the-box" stamping technique for the image pieces. Stamp the images onto two pieces of 3" x 3" white cardstock. Using a ruler and pencil, draw lines around the images, so that each panel measures 2 1/4" x 2 1/4". Trim sides as shown, cutting around the leaves and petals.)



(Images Not
Shown To Scale)

18. Adhere image and saying pieces onto pop-out panel as shown on next page.

19. Stamp "Sending you a bouquet" saying onto 1 1/2" x 2 1/4" white cardstock, and layer onto 1 3/4" x 2 1/2" Wisteria cardstock. Adhere to lower section of card inside.



NOTES: _____

